

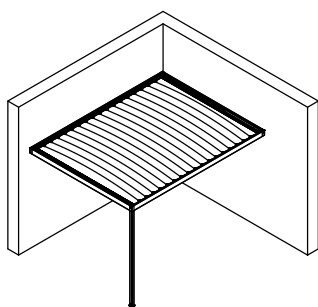

Corradi
OUTDOOR LIVING SPACE

ALBA BUTTERFLY: new features

Butterfly, the folding cover with **pantograph system** that revolutionised the idea of canvas pergola, now also features **wall-mounted configurations** as well as some **new options** topping off the features already presented.



WALL-MOUNTED ON TWO SIDES

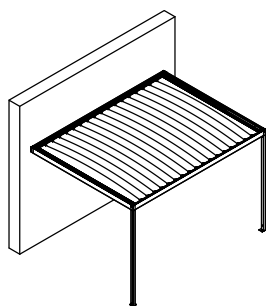

PROJECTION SIDE AGAINST THE WALL

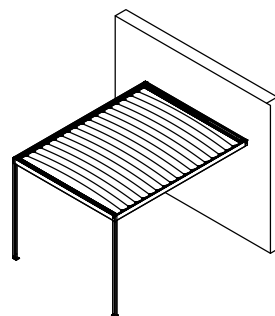

WIDTH SIDE AGAINST THE WALL

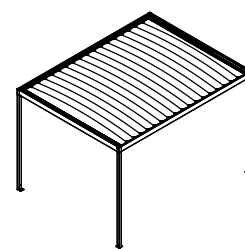

FREESTANDING

Shifted pillar

In addition to the wall-mounted versions, there is now the interesting option of the shifted pillar, which follows Alba's rules in the bioclimatic version and **can be moved, on the projection side only, up to 1/5 of its overall length.**

The shifted pillar is useful for water management **because of the built-in downpipe.**



Corradi Srl

Via M. Serenari, 20 • 40013 Castel Maggiore BO, Italy
T +39 051 4188 411 - E hello@corradi.eu

corradi.eu

Nov 2024

Wall connection link

Alba Butterfly is equipped with a wall connection link that facilitates the drainage of rainwater towards the gutter.

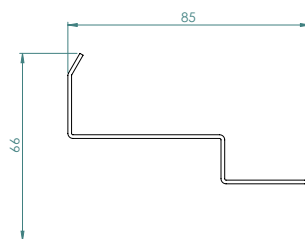

Intermediate pillar

Alba Butterfly still features the chance to install an intermediate pillar which features a **built-in downpipe**.

The standard version of the intermediate pillar uses a visible plate to which it is secured as shown in drawing **A**, together with the standard angle bar plate like perimetral pillars.

The plate can also be used in combination with the shifted pillar.

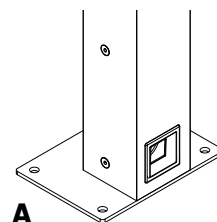

INTERMEDIATE PILLAR
standard

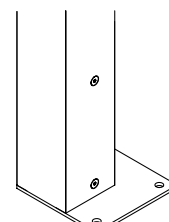

PERIMETRAL PILLAR
standard

Water-tightness

Alba Butterfly freestanding version, in the dimensions 550 x 715 cm - professionally installed - has been water tested with no wind. Measured values are significantly higher than those of class 2 - 56 l/h/m² according to EN 13561:2015 and are also verified for wall-mounted installations.

- approx. 6,500 litres/hour in all dimensions with at least 1 open drain on the width side or on the projection side*
- approx. 9,500 litres/hour in all dimensions with at least 2 open drains on the width side or on the projection side*
- approx. 10,500 litres/hour in all dimensions with at least 3 open drains on the width side or on the projection side*
- approx. 11,000 litres/hour in all dimensions with at least 4 open drains on the width side or on the projection side*

*verified results with properly maintained drains and perfectly level gutter.

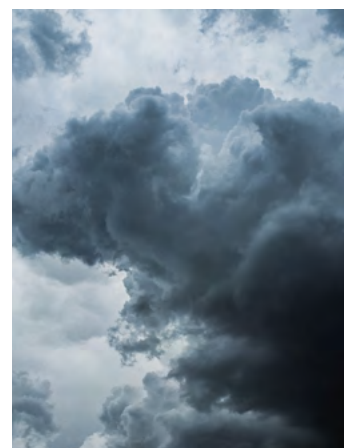

N.B.: Further technical details will be released with the next technical data sheet update.

